

Transmission Housing

Reassembly

NOTE:

- Replace all sealing washers, oil seals and O-rings.
- Always clean the magnet (4) and oil pump cleaner (8).

1. Reassemble the parts following the numbered sequence.

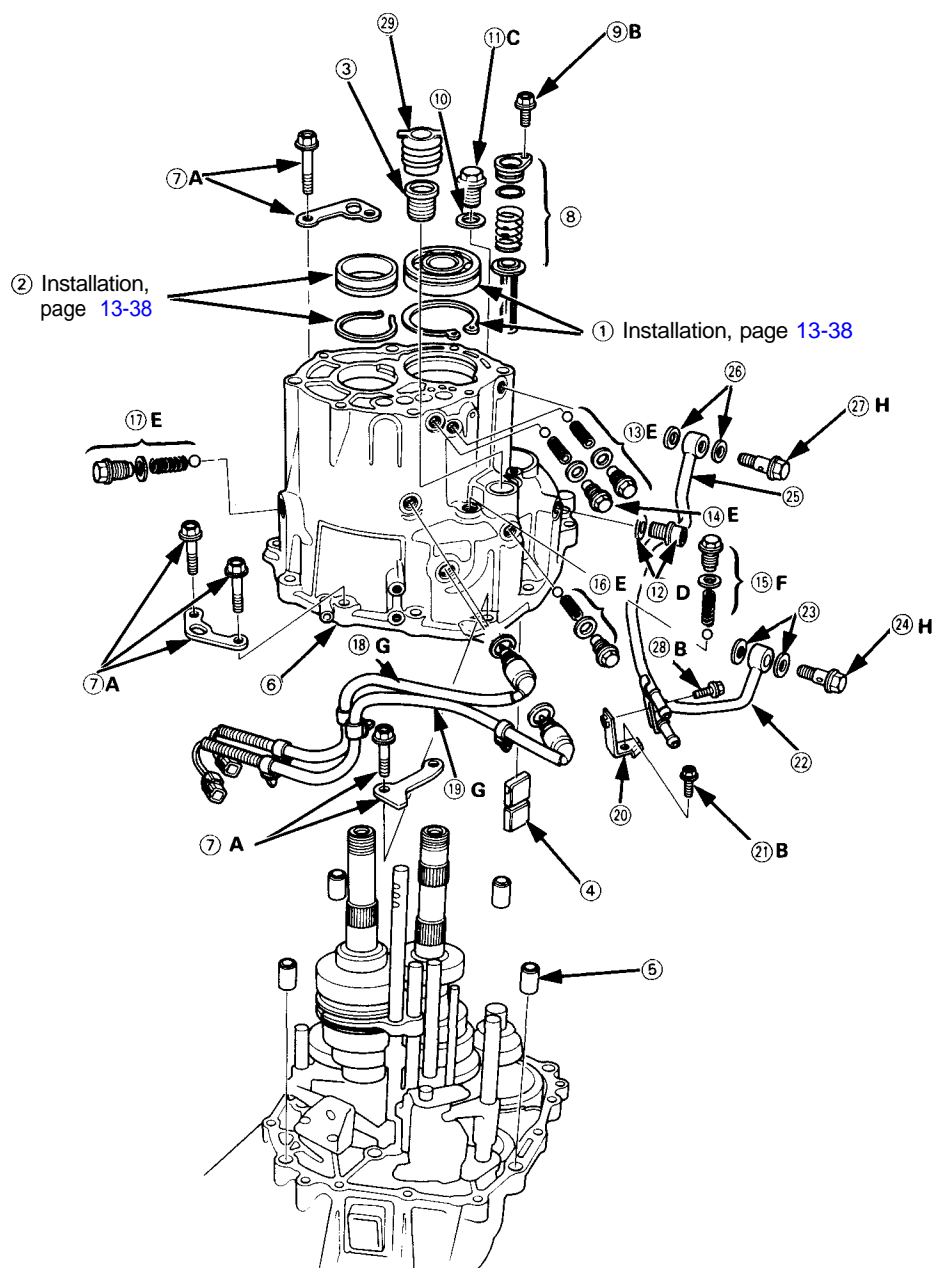



	Bolt Size	Torque Value	Sequence Number
A	10 x 1.25 mm	45 N-m (4.5 kg-m, 33 lb-ft)	(7)
B	6 x 1.0 mm	12 N-m (1.2 kg-m, 9 lb-ft)	(9) (21) (28)
C	DRAIN PLUG	45 N-m (4.5 kg-m, 33 lb-ft)	(11)
D	FILLER PLUG	40 N-m (4.0 kg-m, 29 lb-ft)	(12)
E	12 mm SEALING BOLT	22 N-m (2.2 kg-m, 16 lb-ft)	(13) (14) (16) (17)
F	14 mm SEALING BOLT	33 N-m (3.3 kg-m, 24 lb-ft)	(15)
G	SWITCH	25 N-m (2.5 kg-m, 18 lb-ft)	(18) (19)
H	JOINT BOLT	29 N-m (2.9 kg-m, 21 lb-ft)	(24) (27)

- 1. Apply liquid gasket to the transmission mating surface of the transmission housing.

NOTE: This transmission uses no gasket between the major housings; use Honda Genuine liquid gasket (P/N 08718 – 0001). Assemble the housing within 20 minutes after applying the liquid gasket and allow it to cure at least 30 minutes after assembly before filling it with oil.

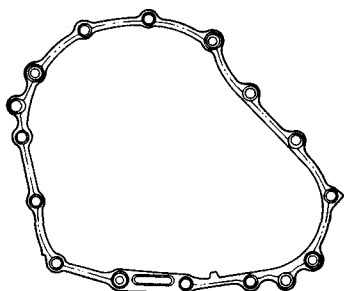

- 2. Install the sealing bolts.

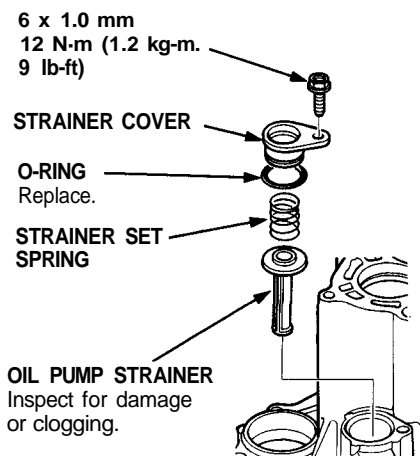

- 3. Tighten the transmission housing attaching bolts in the numbered sequence shown below.

10 x 1.25 mm
50 N-m (5.0 kg-m, 37 lb-ft)

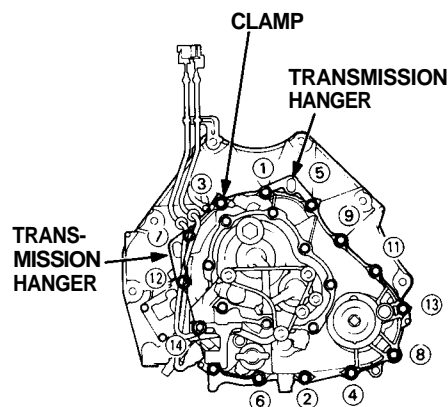

- 4. Install the oil pump cleaner.
Replace all sealing washers.

